

**Proposed decision to be taken by the
Portfolio Holder for Transport and Environment
on or after 18 August 2017**

**THE WARWICKSHIRE COUNTY COUNCIL (B4451 GAYDON
ROAD & STATION ROAD, BISHOPS ITCHINGTON) (30, 40 &
50 MPH SPEED LIMIT) ORDER 2017**

&

**B4451 GAYDON ROAD & STATION ROAD, BISHOPS
ITCHINGTON – PROPOSED TRAFFIC CALMING**

Recommendations

- 1) That the Portfolio Holder for Transport and Environment approves that the Warwickshire County Council, B4451 Gaydon Road & Station Road, Bishops Itchington (30, 40 & 50 mph speed limit) order is implemented as advertised (Appendix 1)
- 2) That the Portfolio Holder for Transport and Environment approves that the Warwickshire County Council, Highways Act 1980, Section 90A, B4451 Gaydon Road & Station Road, Bishops Itchington proposed traffic calming be implemented as advertised (Appendix 2).

1.0 Introduction

- 1.1 Concerns have been raised regarding the speed of motorists through the village of Bishops Itchington, as a result of 3 new housing developments.
- 1.2 A number of meetings have taken place with Warwickshire County Council and Bishops Itchington Parish Council to discuss this matter.
- 1.3 A public consultation exhibition was carried out on the 29/04/2015 (3pm – 7pm).
- 1.3 An initial consultation for the speed limit and the introduction of traffic calming was undertaken in December 2016 with residents along the B4451 Gaydon Road & Station Road and details of the speed limit / traffic calming proposal was uploaded on to the Parish Council web page.
- 1.4 Letters were delivered to 100 residents and 9 responses were received with a number of comments. Although consideration was given to all those

comments received, it has not been possible to accommodate all of these within the proposed scheme. This is due to a variety of reasons i.e physical restraints and highway legislation.

- 1.5 Formal advertisement for the speed limit and proposed traffic calming features was carried out in June 2017.

2.0 Background information

- 2.1 Residents of Bishops Itchington have raised concerns regarding the speed of motorists through the village of Bishops Itchington.
- 2.2 Warwickshire County Council working in conjunction with Bishops Itchington Parish Council have reviewed the existing speed limits and traffic calming within the village of Bishops Itchington.
- 2.3 At present the 30 mph speed limit for Bishop's Itchington is positioned away from the entrance to the village. As part of this scheme Warwickshire County Council are proposing to reposition the 30 mph speed limit terminal signs.
- 2.4 Existing road narrowing's on each approach to the village are to be removed as part of this proposal and additional traffic calming features are to be installed within the length of the 30 mph speed limit.
- 2.5 Warwickshire County Council advertised both a new speed limit order on the 8th June 2017 and a traffic calming notice
- 2.6 In 2007, a new Speed Management Strategy was approved by the County Council as a result of the Speed Limit Circular 01/2006 issued by the Department for Transport (DfT). This has subsequently been superseded by Circular 01/2013. This covers three key areas: Education; Engineering; and Enforcement. The setting of speed limits is a key element of this strategy.
- 2.7 The DfT Circular 01/2013 advises that the following criteria is applied when setting speed limits:
 - (i) Analysing the existing speed data to identify the mean speed of drivers;
 - (ii) To consider the environment and nature of the road; and
 - (iii) To consider any relevant injury accident data.
- 2.8 The DfT Circular 01/2013 places emphasis on community concerns, and refers to the environmental impact of traffic and the level of public anxiety.
- 2.9 B4451 Gaydon Road & Station Road are main arterial roads running from the village of Bishops Itchington.

- 2.10 Traffic survey data collected along the B4451 Gaydon Road / Station Road, Bishops Itchington has been collected and results are shown below. Reducing speed limits can deliver tangible benefits including reducing the frequency and severity of road injury collisions (Appendix 3).

Location	Date	Speed Limit	85%ile	Mean Speed
980084 northbound	12/11/15 – 01/12/15		52.3	44.0
980084 southbound	24/02/16 – 02/03/16		52.8	44.2
30448 northbound	24/02/16 – 02/03/16		38.8	33.0
30448 southbound	24/02/16 – 02/03/16		40.5	35.4
30449 northbound	24/02/16 – 02/03/16		27.7	23.3
30449 southbound	24/02/16 – 02/03/16		31.1	26.7
30452 northbound	24/02/16 – 02/03/16		41.0	35.5
30452 southbound	24/02/16 – 02/03/16		37.0	31.7
30453 northbound	24/02/16 – 02/03/16		34.3	29.1
30453 southbound	24/02/16 – 02/03/16		34.8	29.8

- 2.11 During the period of 17th January 2014 to 7th May 2017 there were 7 recorded personal injury accidents on the B4451 Gaydon Road / Station Road, Bishops Itchington.

	2014	2015	2016	2017	Total
Fatal	0	0	0	0	0
Serious	1	0	0	1	2
Slight	3	1	1	0	5
Total	4	1	1	1	7

3.0 Consultation

- 3.1 Consultation has been carried out with the Local Members, Parish Council, Warwickshire Police, Emergency Services, Road Haulage Association and other statutory consultees.
- 3.2 Legal notices advertising the proposed speed limits were placed in the local newspaper on the 8th June 2017. Notices were also placed on street, and on the Warwickshire Web pages (Appendix 4) advertising the Order and at the Main Reception, Shire Hall, Market Place, Warwick, at the Stratford-upon-

Avon District Council Elizabeth House Church Street Stratford-upon-Avon
Warwickshire CV37 6HX and at the Harbury Community Library The Wight
School High Street Harbury Leamington Spa CV33 9HW

4.0 Support / Objections

- 4.1 The following objections were received (full details in background papers and summary below)
- 4.2 Nine letters received from the informal consultation in December 2016 are shown in background papers.

Support

County Councillor Stevens is supportive of this proposal.

Bishops Itchington Parish Council is supportive of this proposal.

Objection

Objection 1 – Resident

Reinforce a point mentioned previously – gateway is situated close to the drive that serves a number of houses. Access to drive is hazardous due to volume of traffic and visibility. Sighting of the gateway will further inhibit visibility.

Response

The feature is situated approximately 15m east of the access and apart from the speed limit sign plates which will be positioned above the sight line, visibility should not be affected.

Objection 2 – Resident

In response to the informal consultation 9 letters received - nothing has changed, waste of time and effort.

Object to speed cushions along Gaydon Road particularly outside No 37. Prove they do not work, causes braking, accelerating, pollution, noise and danger.

Will sue the Council on their intrusion (noise) they create and the structural damage (vibration) they cause.

Response

Speed cushions are a less severe type of raised feature and most vehicles will be able to straddle all but the edges of the cushion and hence noise and vibration is

minimised. The raised table is at a junction where vehicles are required to slow and give way so will be negotiated at lower speed. The entry and exit slopes will be the longer of 2 options at 1.5m so will not be a severe change in level.

Objection 3 – Resident

Objects to the lack of additional speed cushions along the B4451 Gaydon Road between the proposed 30 mph speed limit sign and the last proposed speed cushion along this section of road.

Lack of speed cushions will allow vehicles to speed.

Recent collision, motorist travel well above the 30 mph speed limit, hazardous for pedestrians and residents turning out of their driveways.

Increase in traffic from M40 and JLR.

More detail required on proposed gateway feature, signage, large planters and road narrowing and other features would be of use.

Why is the last speed cushion for vehicles travelling out of the village towards Gaydon is quite far in to the village and why is there not an additional one closer to the speed limit.

Response

The gateway feature will be just the Dragons Teeth road marking and the speed limit signs. There are challenging physical issues as to why there is no speed cushion proposed within closer proximity of the speed limit. These include the gradient of the carriageway and the number of private driveways.

Objection 4 – Resident

Can you confirm - are you building another gateway feature, is this a narrowing of the road with priority signage, are you removing the current 1 way traffic flow on this section of the village.

Recent serious accident not enough speed reductions added.

Response

The gateway feature is simply the Dragons Teeth road marking and the speed limit signs. There are no proposed narrowing's. The existing narrowing's on Station Road and Gaydon Road are to be removed. As the 30mph speed limit is proposed to be located nearer to the village, drivers will appreciate the justification for this, which should result in more appropriate speeds. The village gateways i.e. dragon's teeth, markings and signs have been used elsewhere within the County which have been effective at reducing the speed of vehicles. These types of measures are also recommended by the Department for Transport in these types of locations.

Objection 5 – Police

Warwickshire Police object to the removal of the existing build outs, the re positioning of the 30 mph terminal signs.

Current visibility splay for Marlow Green does not meet the required design standards for the actual 85%ile speed of 37 mph.

Build out from Gaydon direction has been working and slows traffic, no RTC at the build out.

Proposal will see an increase in speed and may lead to collisions.

Response

The objective of this proposed scheme is to reduce the speed of vehicles throughout the residential section of the village. The narrowings are currently located outside of this section and by introducing a more appropriate 30mph speed limit with the proposed associated measures, will achieve this. There is evidence that the narrowings have been hit on several occasions, albeit resulting in damage only accidents rather than injury accidents. The Road Safety Audit did not identify any visibility issues.

Recommendation

- 1) That the Portfolio Holder for Transport and Environment approves that the Warwickshire County Council, B4451 Gaydon Road & Station Road, Bishops Itchington (30, 40 & 50 mph speed limit) order is implemented as advertised.
- 2) That the Portfolio Holder for Transport and Environment approves that the Warwickshire County Council, Highways Act 1980, Section 90A, B4451 Gaydon Road & Station Road, Bishops Itchington proposed traffic calming be considered and implemented as advertised.

5.0 Financial Implications

- 5.1 All works associated with this proposed speed limit and traffic calming will be funded through Section 106 developer contributions arising from developments within Bishops Itchington.

6.0 Background Papers

Correspondence

	Name	Contact Information
Report Author	Jo Edwards	joedwards@warwickshire.gov.uk Tel: 01926 412414
Head of Service	Mark Ryder	markryder@warwickshire.gov.uk
Strategic Director	Monica Fogarty	monicafogarty@warwickshire.gov.uk
Portfolio Holder	Councillor Jeff Clarke	

This report was circulated to the following elected members prior to publication

Local Member: Cllr Stevens

Other members: Cllrs Horner, Western, Cockburn, Shilton, Fradgley

WARWICKSHIRE COUNTY COUNCIL

ROAD TRAFFIC REGULATION ACT 1984

**THE WARWICKSHIRE COUNTY COUNCIL (B4451 GAYDON ROAD & STATION ROAD,
BISHOPS ITCHINGTON) (30, 40 & 50 MPH SPEED LIMIT) ORDER 2017**

Warwickshire County Council propose to make the above Order under the Road Traffic Regulation Act 1984 the effect of which will be to impose 30, 40 & 50 mph speed limits on the lengths of road mentioned in the Schedules below.

A copy of the proposed Order, together with a plan showing the length of road affected and a statement of the Council's reasons for proposing to make the Order, may be inspected at the Main Reception, Shire Hall, Market Place, Warwick, at the Stratford-upon-Avon District Council Elizabeth House Church Street Stratford-upon-Avon Warwickshire CV37 6HX and at the Harbury Community Library The Wight School High Street Harbury Leamington Spa CV33 9HW during usual opening hours.

Any enquiries relating to the proposals may be made to Debbie Poynton, Communities Group, Warwickshire County Council (telephone number: 01926 412076).

Any objections to the proposals, which must be in writing and specify the grounds on which they are made, should be addressed to Debbie Poynton, Communities Group, PO Box 43, Shire Hall, Warwick, CV34 4SX. (Objections, and the name of the objector, will normally be treated as public information and may be published.) Objections must be sent so as to be received by 7 July 2017.

SCHEDULE 1

(30 mph Speed Limit)

Length of road in Bishop's Itchington

1. **B4451 Gaydon Road & Station Road**

That length of road from a point 64 metres south west of the boundary between property number 41 / 43 Gaydon Road in a generally north easterly then north westerly direction to a point 119 metres north west of the junction with Marlow Green (centre of junction)

2. **Plough Lane**

From its junction with the B4451 Gaydon Road in a north westerly direction to a point 73 metres north west of its junction with Manor Road (centre of junction).

3. **Knightcote Road**

From its junction with the B4451 Gaydon Road in a generally south easterly direction for a distance of 216 metres.

SCHEDULE 2
(40 mph Speed Limit)

1. B4451 Gaydon Road

That length of road from a point 737 metres south west of its junction with Knightcote Road in a generally north easterly direction to a point 64 metres south west of the property boundary between property number 41 / 43 Gaydon Road.

2. B4451 Station Road

That length of road from a point 119 metres north of the junction with Marlow Green in a north easterly direction to a point 21 metres north of the boundary between Walworth Farm and the Chapel Cemetery.

SCHEDULE 3
(50 mph Speed Limit)

1. B4451 Station Road

That length of road from a point 21 metres north of the boundary between Walworth Farm and the Chapel Cemetery to its junction with the B4452 / B4451 Deppers Bridge Road.

SCHEDULE 4
(Provisions that are revoked)

1. The Warwickshire County Council (40 M.P.H SPEED LIMIT) (B4451 BISHOPS ITCHINGTON) ORDER, 1971 (Entire Order)
2. THE WARWICKSHIRE COUNTY COUNCIL (PLOUGH LANE, BISHOPS ITCHINGTON)(40 M.P.H SPEED LIMIT) ORDER 1994 – (No 289) (Entire Order)
3. THE WARWICKSHIRE COUNTY COUNCIL (VARIOUS ROADS, DISTRICT OF STRATFORD ON AVON) (SPEED LIMIT) ORDER 2009 – (No 483)

Schedule 1 (50 MPH SPEED LIMIT)

Item 30

B4451 Deppers Bridge / Station Road

From its junction with the B4451 Deppers Bridge, southwards for a distance of 850 metres

4. The Warwickshire County Council (B4100 Banbury Road, B4100 Warwick Road, B4100 Link Road, B4451 Gaydon Road, Gaydon, Bishops Itchington and Lighthorne Heath) (40 MPH & 50 MPH Speed Limit & 30 MPH Speed Limit Variation) Order 2016

Schedule 1 (40mph Speed Limits)

Item 2

B4451 Gaydon Road, Bishops Itchington

From a point 427 metres south west of its junction with Knightcote Road, south westwards for a distance of 310 metres.

S Duxbury
Head of Law & Governance

Shire Hall, Warwick
8 June 2017

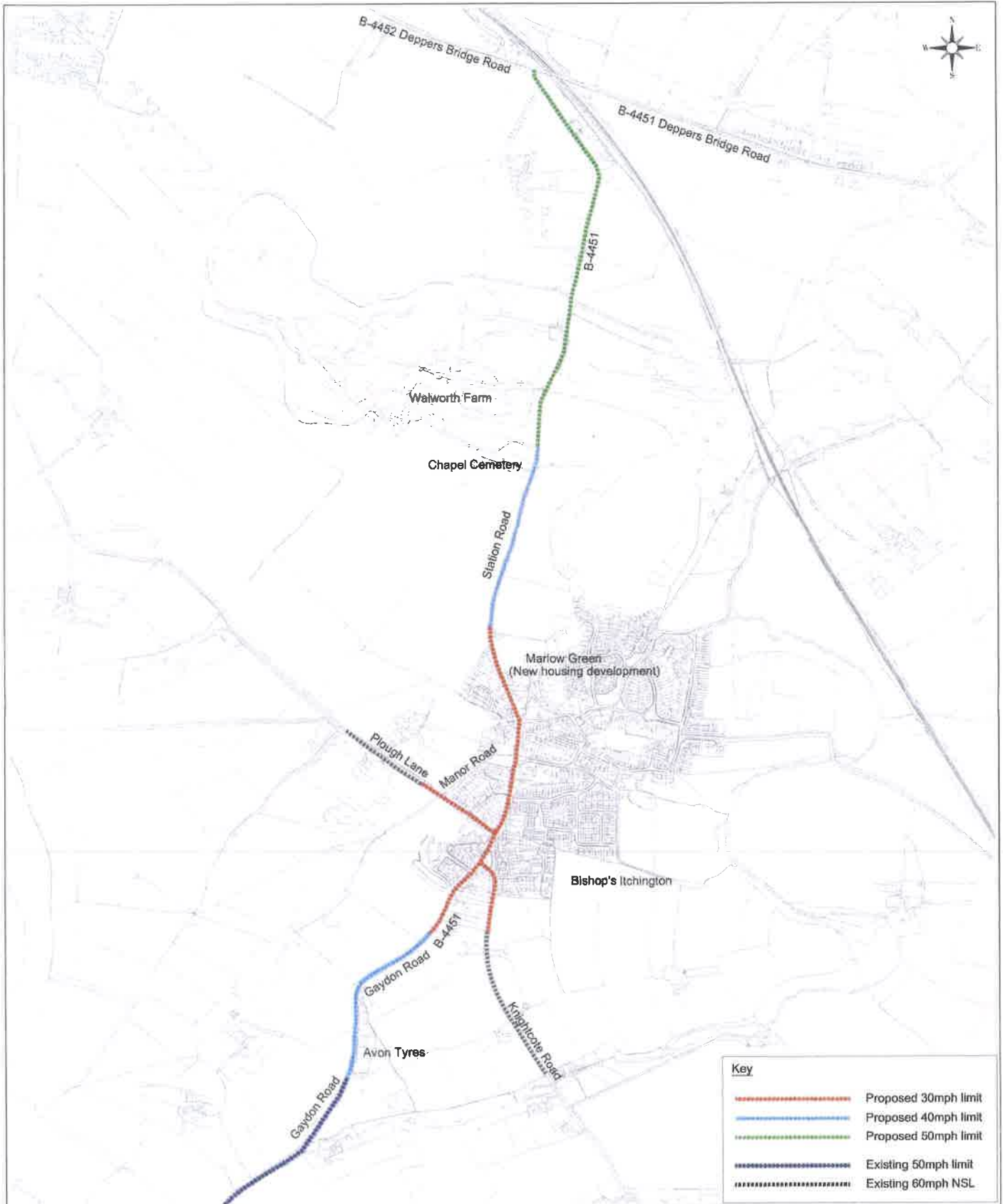

REV	DATE	BY	CHK	AMENDMENT	REV	DATE	BY	CHK	AMENDMENT	REV	DATE	BY	CHK	AMENDMENT
A	05/05/17	EM	-	To include additional route/road	-	-/-	-	-	-	-	-/-	-	-	-
-	-/-	-	-	-	-	-/-	-	-	-	-	-/-	-	-	-

Warwickshire County Council
TRANSPORT AND ECONOMY
 www.warwickshire.gov.uk
 email: transport@warwickshire.gov.uk

Traffic & Road Safety
 Communities,
 Shire Hall Post Room
 Warwick, CV40 40P
 Tel: 01926 410410

NOTES

H:\Traffic\AA_PROJECT SUPPORT\Bishops Itchington\Speed Limit Scheme\Drawings\TR-10056.dwg

Based on Ordnance Survey mapping with the permission of the Controller of HMSO
 © Crown Copyright and database right 2011 Ordnance Survey 100019520
 All rights reserved
 Unauthorised reproduction infringes copyright and may lead to prosecution or civil proceedings
 Warwickshire County Council

Drawing title

**B-4451
Gaydon Road - Station Road**

Project title

Bishops Itchington Speed Limit Scheme

Drawn by	Checked by
FM	JC
Date	
7 November 2016	
Scale	
1:10000 @ A3_P	
Drawing number	
TR-10056-01	

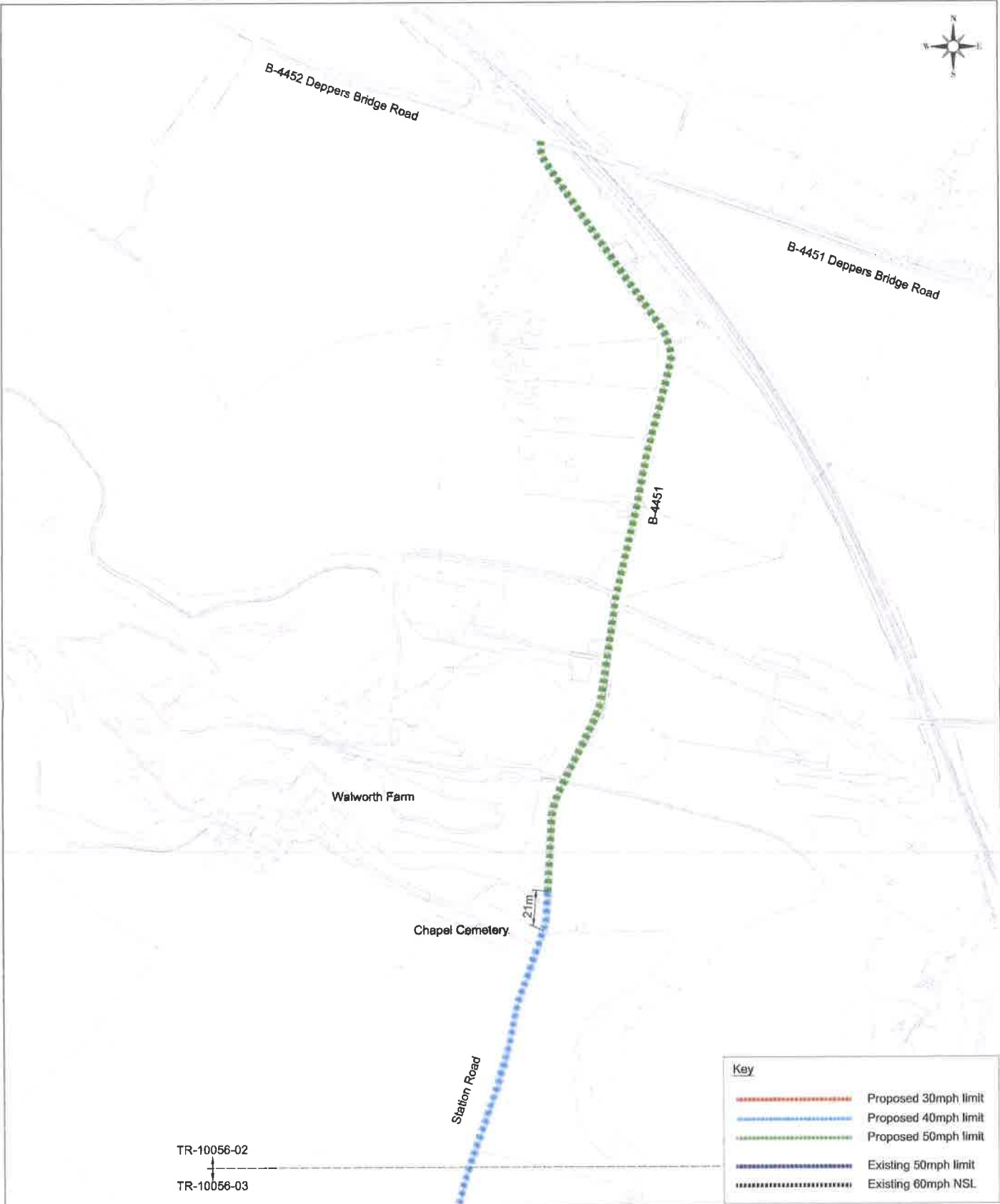

TR-10056-02
 TR-10056-03

Key	
	Proposed 30mph limit
	Proposed 40mph limit
	Proposed 50mph limit
	Existing 50mph limit
	Existing 60mph NSL

REV	DATE	BY	CHK	AMENDMENT	REV	DATE	BY	CHK	AMENDMENT	REV	DATE	BY	CHK	AMENDMENT
-	-/-	-	-	-	-	-/-	-	-	-	-	-/-	-	-	-
-	-/-	-	-	-	-	-/-	-	-	-	-	-/-	-	-	-



Traffic & Road Safety
 Communities,
 Sharn Hall Post Room
 Warwick, CV34 4SP
 Tel: 01926 410410

NOTES

H:\Traffic\AA_PROJECT SUPPORT\Bishops Itchington\Speed Limit Scheme\drawings\TR-10056.dwg
 Based on Ordnance Survey mapping with the permission of the Controller of HMSO
 © Crown Copyright and database right 2011. Ordnance Survey 100019105
 All rights reserved.
 Unauthorised reproduction in any form is prohibited and may lead to prosecution or civil proceedings
 Warwickshire County Council

Drawing title
**B-4451
 Station Road**

Project title
Bishops Itchington Speed Limit Scheme

Drawn by FM	Checked by FE
Date 7 November 2016	
Scale 1:5000 @ A3_P	
Drawing number TR-10056-02	

TR-10056-02
 TR-10056-03

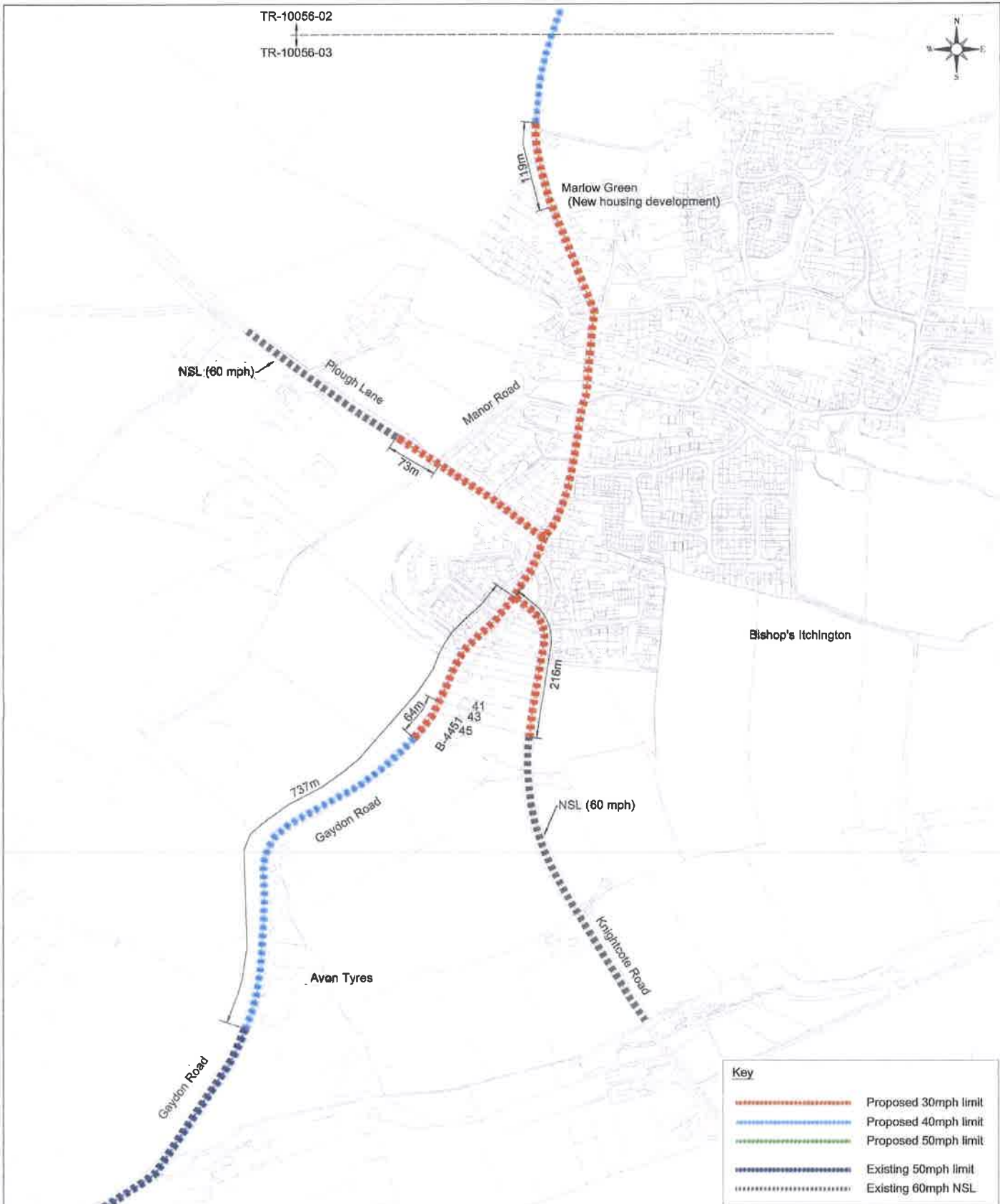

REV	DATE	BY	CHK	AMENDMENT	REV	DATE	BY	CHK	AMENDMENT	REV	DATE	BY	CHK	AMENDMENT
A	05/05/17	EM	-	To Include additional route/road	-	-/-	-	-	-	-	-/-	-	-	-
-	-/-	-	-	-	-	-/-	-	-	-	-	-/-	-	-	-

Warwickshire County Council
TRANSPORT AND ECONOMY

Traffic & Road Safety
 Contrivance:
 Shire Hall Post Room
 Warwick, CV4 4BP
 Tel: 01929 410410

www.warwickshire.gov.uk
multimedia@warwickshire.gov.uk

NOTES

H:\Traffic\AA_PROJECT SUPPORT\Bishops Itchington\Speed Limit Scheme\Drawings\TR-10056.dwg
 Based on Ordnance Survey mapping with the permission of the Controller of HMSO
 © Crown Copyright and database right 2011. Ordnance Survey 100019220
 All rights reserved
 Unauthorised reproduction (without copyright) will *not* lead to prosecution or civil proceedings
 Warwickshire County Council

Drawing title
**B-4451
 Gaydon Road**

Project title
Bishops Itchington Speed Limit Scheme

Drawn by
FM

Checked by
JC

Date
7 November 2016

Scale
1:5000 @ A3_P

Drawing number
TR-10056-03

WARWICKSHIRE COUNTY COUNCIL**HIGHWAYS ACT 1980, SECTION 90G****B4451 GAYDON ROAD & STATION ROAD, BISHOPS ITCHINGTON – PROPOSED TRAFFIC CALMING**

Warwickshire County Council propose to install traffic calming measures as described and in the locations outlined in the Schedule below in Bishops Itchington.

A copy of the plan showing the proposed locations of the traffic calming measures and a statement of the Council's reasons for proposing to install them may be inspected at the Main Reception, Shire Hall, Market Place, Warwick; at the Stratford-upon-Avon District Council Elizabeth House Church Street Stratford-upon-Avon Warwickshire CV37 6HX and at the Harbury Community Library The Wight School High Street Harbury Leamington Spa CV33 9HW during usual opening hours.

Any enquiries relating to the proposals may be made to Debbie Poynton, Communities Group, Warwickshire County Council (telephone number: 01926 412076). Any objections to the proposals, which must be in writing and specify the grounds on which they are made, should be addressed to Debbie Poynton, Communities Group, PO Box 43, Shire Hall, Warwick, CV34 4SX. (Objections, and the name of the objector, will normally be treated as public information and may be published.) Objections must be sent so as to be received by 7 July 2017.

SCHEDULE**B4451 Gaydon Road**

- 1 No. 75mm high speed cushions (two cushions at each location) to be located outside property number 37 Gaydon Road.
- 1 No. 75mm high speed cushions (two cushions at each location) to be located between property number 29 and 27 Gayon Road.
- 1 No. 75mm high speed cushions (two cushions at each location) to be located to the northeast of the junction with Knightcote Road, speed cushion is to be in line with the existing manhole cover.
- 1 No.75mm high raised table at the junction with Plough Lane
- 1 No. 75mm high speed cushions (two cushions at each location) to be located outside property number 6 Gaydon Road.
- 1 No. 75mm high speed cushions (two cushions at each location) to be located outside property number 5 Gaydon Road.

B4451 Station Road

- 1 No. 75mm high speed cushions (two cushions at each location) to be located outside property number 4 Station Road.

- 1 No. 75mm high speed cushions (two cushions at each location) to be located outside property number 19A Station Road, cushion will be in line with the existing school sign.

S Duxbury
Head of Law & Governance

Shire Hall, Warwick
8 June 2017

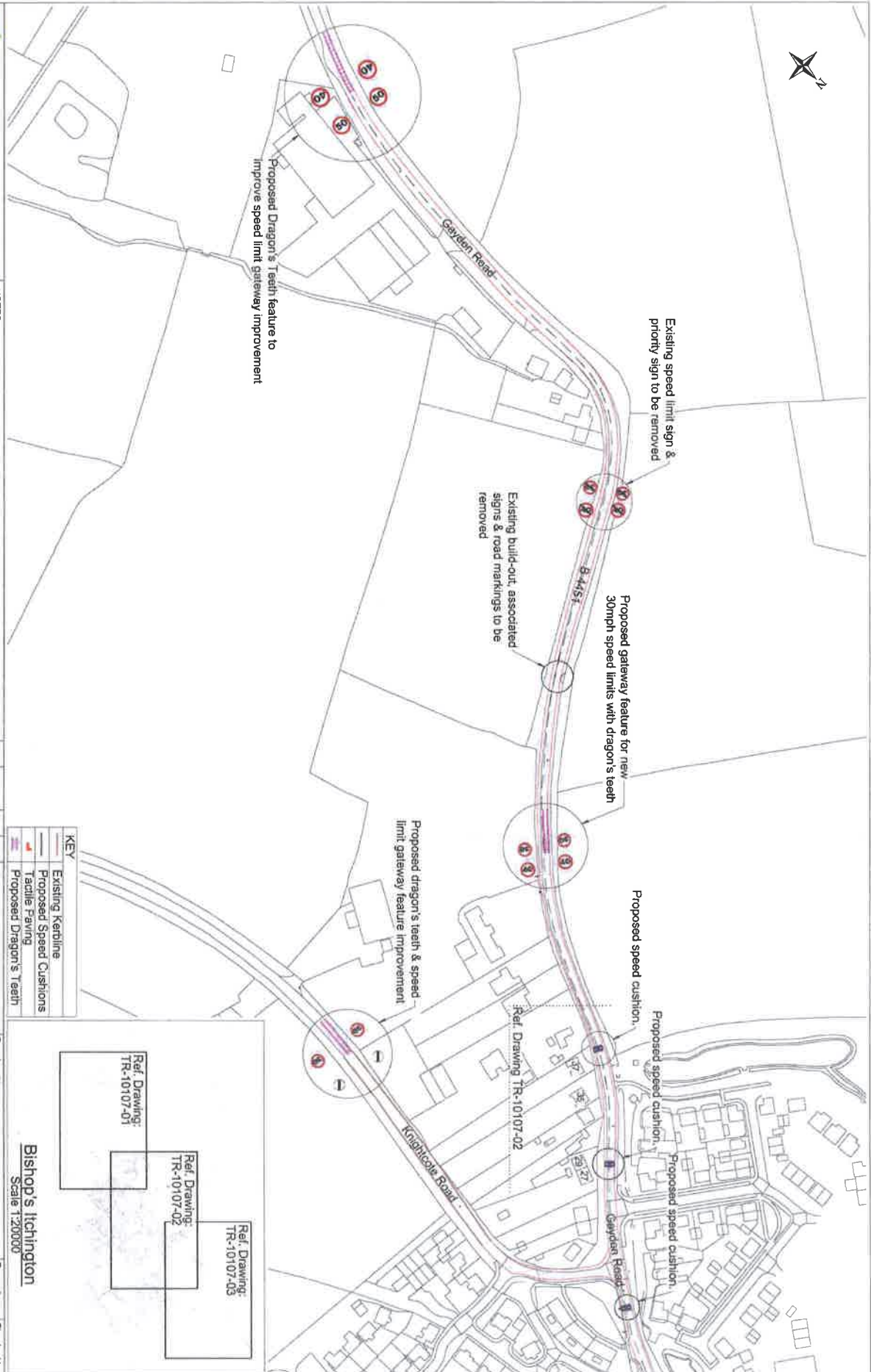

Warwickshire County Council
TRANSPORT AND ECONOMY
 Warwick, CV34 4EP
 Tel: 01926 410010

Traffic & Road Safety
 Consulting Room
 Warwick, CV34 4EP
 Tel: 01926 410010

NOTES

REV	DATE	BY	CHK	AMENDMENT
-	-	-	-	-
-	-	-	-	-
-	-	-	-	-
-	-	-	-	-

KEY

- Existing Kerblines
- Proposed Speed Cushions
- Tactical T-ving
- Proposed Dragon's Teeth

Bishop's Itchington
 Scale 1:20000

Ref. Drawing: TR-10107-03

Ref. Drawing: TR-10107-02

Ref. Drawing: TR-10107-01

Drawing title: **Bishop's Itchington**

Project title: **B4451 - Gaydon Road**

Drawn by: **FM** / Checked by: **AK**

Date: **20 December 2016**

Scale: **1:2000 @ A3 L**

Drawing number: **TR-10107-01**

H:\Traffic\A3 PROJECT SUPPORT\Workshop\Itchington\B4451_Traffic_Calmings\TR-10107-01.dwg
 Created in: Oracle Survey software with the permission of the Controller of Her Majesty's Stationery Office, London, 2011. Copyright Survey 2009/16/00
 Under the terms of the Ordnance Survey Licence, the user must not reproduce, store, or transmit any data, in any form, or by any means, without the prior written permission of the Controller of Her Majesty's Stationery Office.

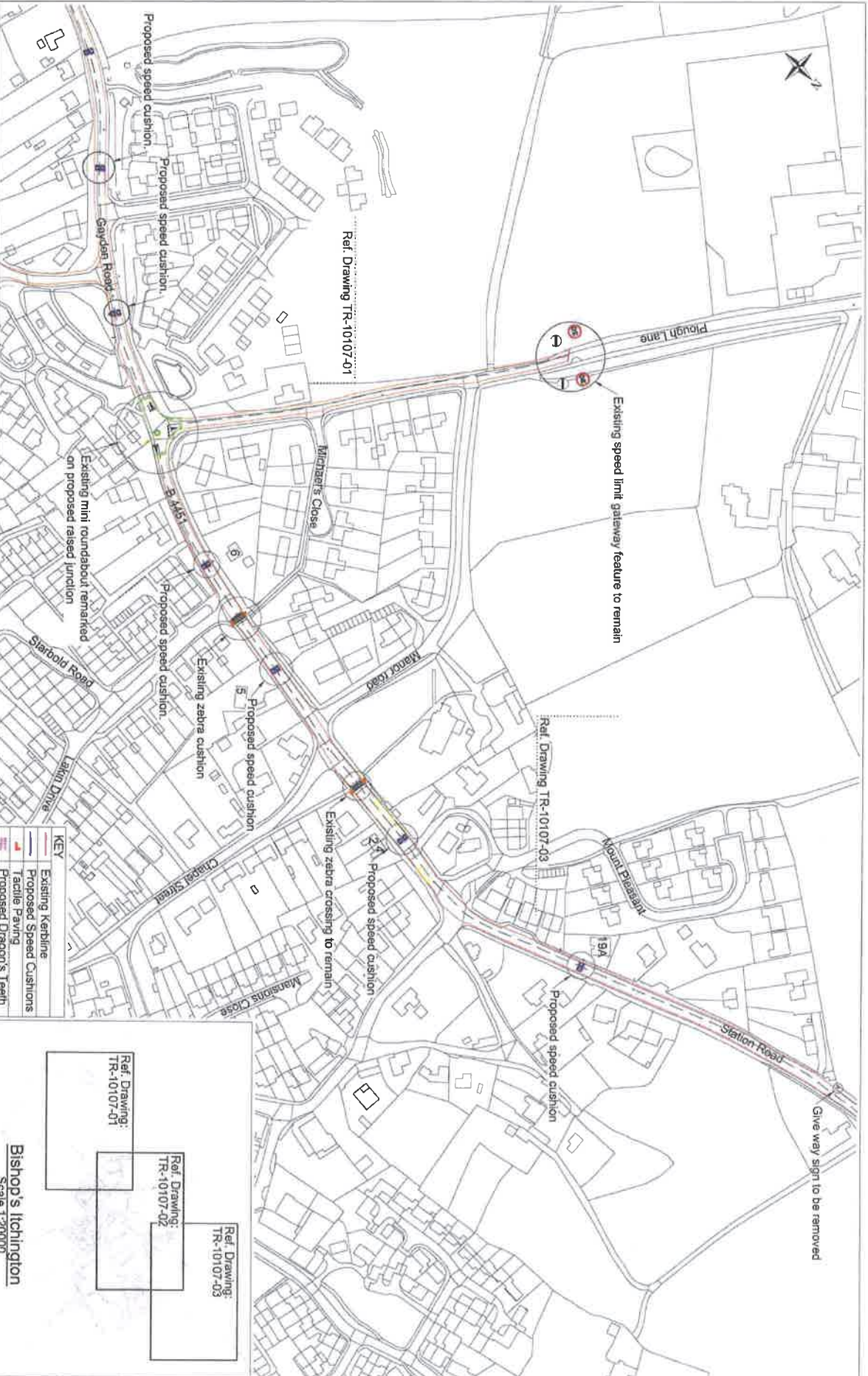

Warwickshire
County Council
**TRANSPORT
AND ECONOMY**

Traffic & Road Safety
View all the Roads
We're Caring For
To Street View

NOTES

1. ALL WORKS TO BE COMPLETED BY THE END OF 2016.
2. ALL WORKS TO BE COMPLETED BY THE END OF 2016.
3. ALL WORKS TO BE COMPLETED BY THE END OF 2016.
4. ALL WORKS TO BE COMPLETED BY THE END OF 2016.
5. ALL WORKS TO BE COMPLETED BY THE END OF 2016.
6. ALL WORKS TO BE COMPLETED BY THE END OF 2016.

REV	DATE	BY	CHK	AMENDMENT
1-1				
1-1				
1-1				
1-1				
1-1				

KEY	DESCRIPTION
	Existing Kerblime
	Proposed Speed Cushions
	Facile Pavng
	Proposed Dragon's Teeth

Bishop's Itchington
Scale 1:20000

Ref. Drawing: TR-10107-03
Ref. Drawing: TR-10107-02
Ref. Drawing: TR-10107-01

Drawing title
**Bishop's Itchington
Traffic Calming Proposals
Purpose of Drawing:
Feasibility Drawing 2**

Project title
BA451 - Gaydon Road

Drawn by
FM

Checked by
JK

Date
20 December 2016

Scale
1:2000 @ A3 L

Drawing number
TR-10107-02

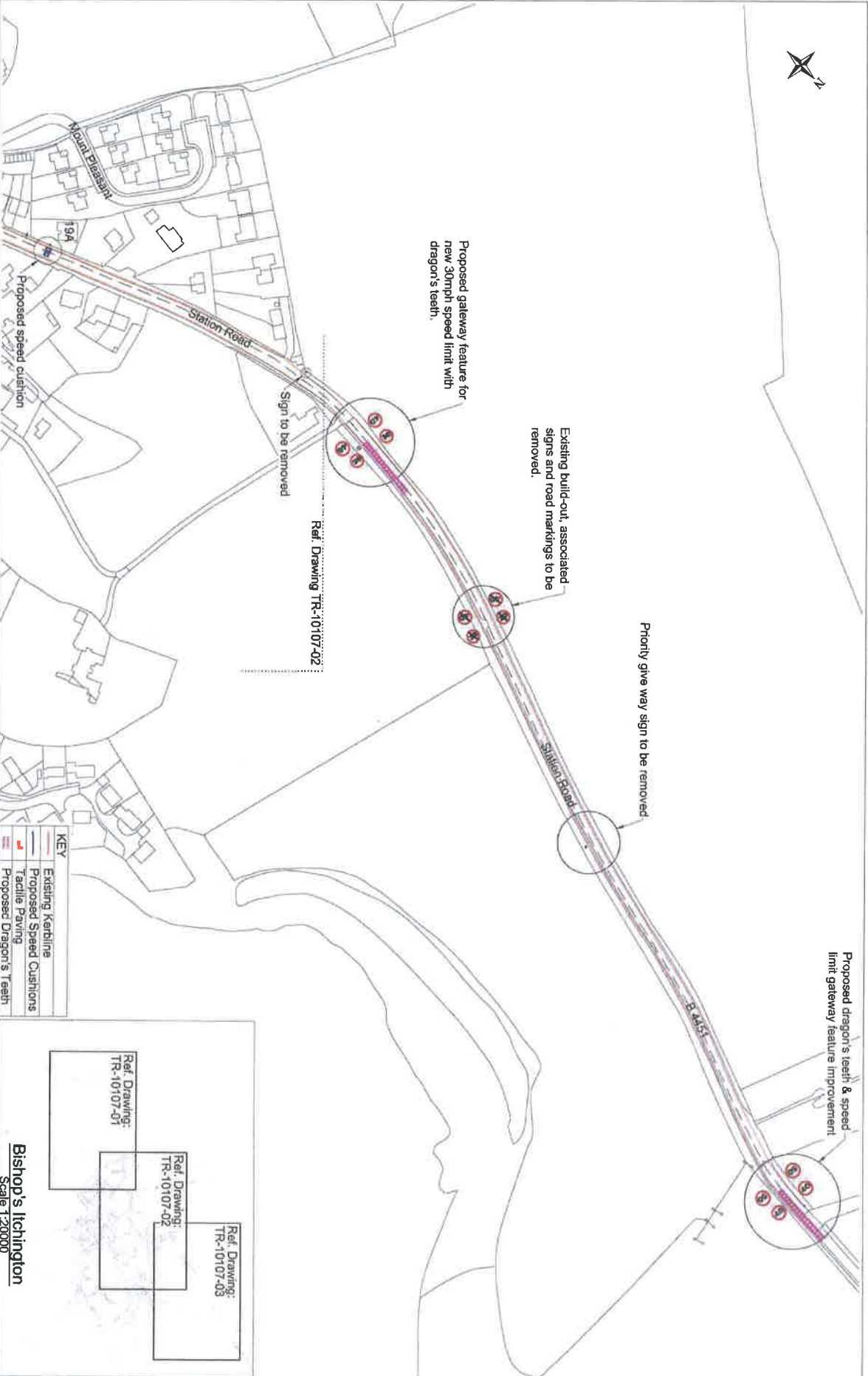

Warwickshire County Council
TRANSPORT AND ECONOMY
 Traffic & Road Safety
 Commercial, Give the Road Room
 1st Floor, 14-16
 The Street, Warwick
 CV34 4AF
 Tel: 01927 194100
 Email: transport@warwickshire.gov.uk

NOTES
 1. THIS DRAWING IS A FEASIBILITY STUDY AND DOES NOT REPRESENT A COMMITMENT BY THE COUNCIL.
 2. THE COUNCIL DOES NOT ACCEPT LIABILITY FOR ANY LOSS OR DAMAGE CAUSED BY THE USE OF THIS DRAWING.
 3. ALL RIGHTS RESERVED.

REV	DATE	BY	CHK	AMENDMENT
-	-	-	-	-
-	-	-	-	-
-	-	-	-	-
-	-	-	-	-

KEY

-  Existing Kerbline
-  Proposed Speed Cushions
-  Tactile Paving
-  Proposed Dragon's Teeth

Bishop's Itchington
Scale 1:20000

Ref. Drawing: TR-10107-03
 Ref. Drawing: TR-10107-02
 Ref. Drawing: TR-10107-01

Drawing title
Bishop's Itchington Traffic Calming Proposals Purpose of Drawing: Feasibility Drawing 3
 Project title
B4451 - Gaydon Road
 Drawn by: FMJ
 Checked by: JKC
 Date: 20 December 2016
 Scale: 1:2000 @ A3_L
 Drawing number: TR-10107-03

Appendix 3.

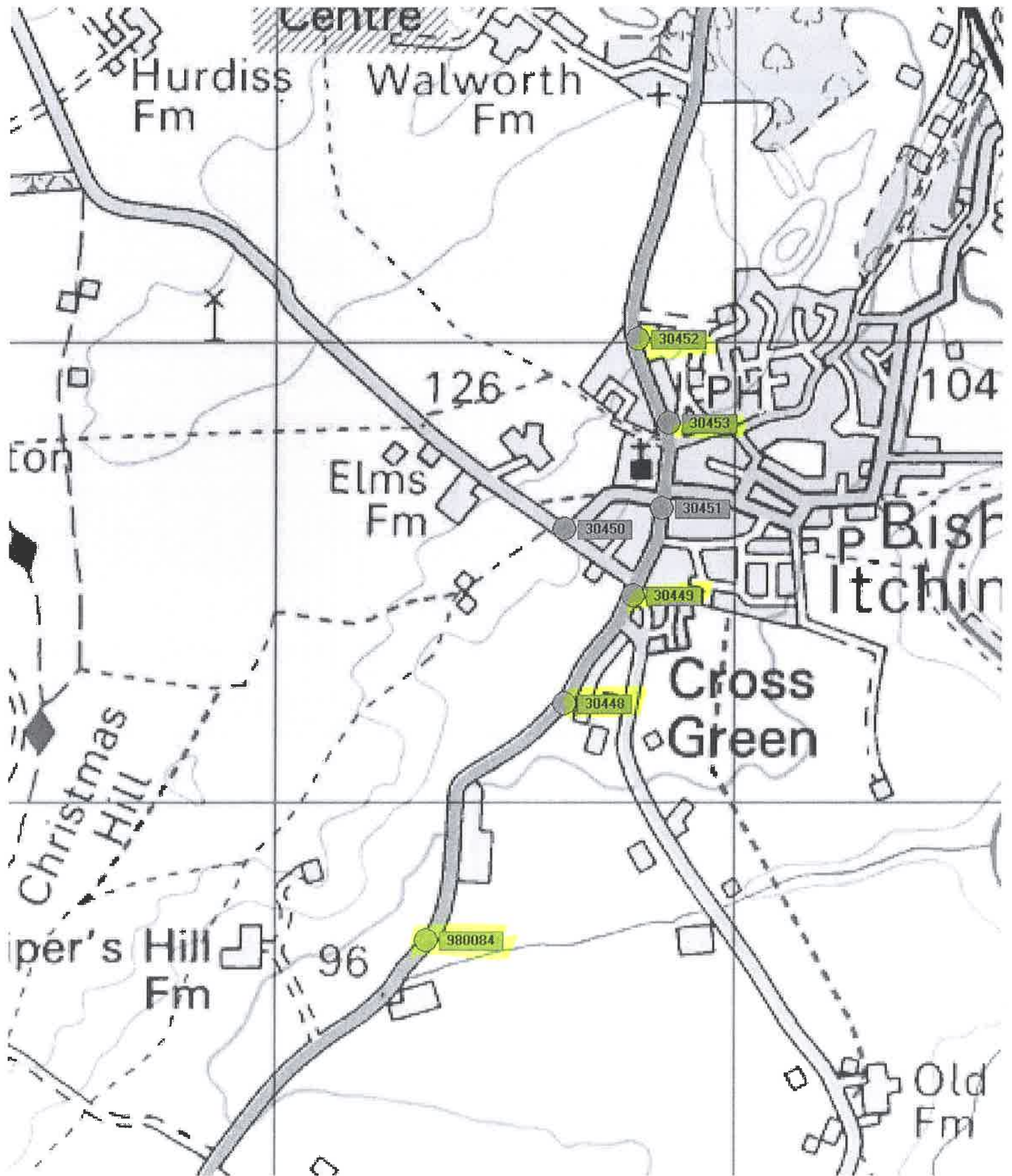

B4451 Gaydon Rd, Bishops Itchington (E-W monitor)
From 12/11/2015 To 01/12/2015

Speed Summary (Mon to Fri)-Limit 60 Mph

Channel: Northbound

Time	Total Vol.	85th %ile	Mean Ave.	Std. Dev.	Bin 1 <46Mph	Bin 2 46-<51	Bin 3 51-<56	Bin 4 56-<61	Bin 5 61-<66	Bin 6 66-<71	Bin 7 71-<76	Bin 8 76-<81	Bin 9 81-<86	Bin 10 86-<91	Bin 11 91-<96	Bin 12 96-<101	Bin 13 =>101
0:00	4	-	44.8	9.3	1	1	0	0	0	0	0	0	0	0	0	0	0
1:00	1	-	46.7	10.1	0	0	0	0	0	0	0	0	0	0	0	0	0
2:00	2	-	46.0	-	0	0	0	0	0	0	0	0	0	0	0	0	0
3:00	3	-	43.5	8.8	2	1	0	0	0	0	0	0	0	0	0	0	0
4:00	11	54.7	47.1	9.2	4	3	3	1	0	0	0	0	0	0	0	0	0
5:00	78	55.9	49.7	7.5	15	28	24	9	1	0	0	0	0	0	0	0	0
6:00	328	53.3	45.8	8.2	120	135	55	14	4	0	0	0	0	0	0	0	0
7:00	204	53.6	45.8	8.3	77	78	38	9	3	0	0	0	0	0	0	0	0
8:00	248	52.3	44.4	8.4	113	88	36	8	2	0	0	0	0	0	0	0	0
9:00	156	51.1	43.3	8.3	84	49	17	5	0	0	0	0	0	0	0	0	0
10:00	114	51.1	43.0	8.5	66	31	13	4	0	0	0	0	0	0	0	0	0
11:00	110	50.9	42.5	8.5	66	28	13	4	0	0	0	0	0	0	0	0	0
12:00	124	50.1	41.7	8.0	80	30	10	3	0	0	0	0	0	0	0	0	0
13:00	119	50.3	42.2	8.3	72	32	10	3	0	0	0	0	0	0	0	0	0
14:00	116	52.0	43.2	8.6	65	32	16	4	1	0	0	0	0	0	0	0	0
15:00	131	51.9	43.5	8.6	68	38	17	4	0	0	0	0	0	0	0	0	0
16:00	161	50.5	42.5	8.2	93	47	15	4	0	0	0	0	0	0	0	0	0
17:00	169	51.2	43.2	8.3	91	51	21	4	0	0	0	0	0	0	0	0	0
18:00	105	53.3	44.8	8.6	47	34	15	7	1	0	0	0	0	0	0	0	0
19:00	57	53.6	45.7	8.5	22	20	9	3	0	0	0	0	0	0	0	0	0
20:00	36	53.7	45.1	9.0	17	10	6	1	0	0	0	0	0	0	0	0	0
21:00	28	54.0	45.1	9.3	12	8	4	2	0	0	0	0	0	0	0	0	0
22:00	20	54.8	46.3	8.9	8	6	5	2	0	0	0	0	0	0	0	0	0
23:00	10	-	47.7	8.9	3	4	3	0	0	0	0	0	0	0	0	0	0
12H:7-19	1757	51.6	43.4	8.2	922	538	220	60	7	0	0	0	0	0	0	0	0
16H:6-22	2206	52.0	43.8	8.2	1094	710	294	81	11	0	0	0	0	0	0	0	0
18H:6-24	2236	52.0	43.8	8.2	1105	720	301	83	11	0	0	0	0	0	0	0	0
24H:0-24	2335	52.3	44.0	8.3	1127	753	328	93	13	0	0	0	0	0	0	0	0
Am Peak	6:15 336	-	5:00 49.7	-	6:15 131	6:15 134	5:45 56	5:30 17	5:45 5	6:15 1	6:15 0	10:45 0	6:00 0	-	-	-	10:15 0
Pm Peak	16:45 170	-	23:00 47.7	9.4	16:15 102	17:00 51	17:15 21	18:00 7	14:45 2	22:30 0	17:15 0	23:00 0	-	-	-	-	-

Includes Local Events, Includes Global Events

B4451 Gaydon Rd, Bishops Itchington (E-W monitor)
From 12/11/2015 To 01/12/2015

Speed Summary (Mon to Fri)-Limit 60 Mph

Channel: Southbound

Time Begin	Total Vol.	85th %ile	Mean Ave.	Std. Dev.	Bin 1 <46Mph	Bin 2 46-<51	Bin 3 51-<56	Bin 4 56-<61	Bin 5 61-<66	Bin 6 66-<71	Bin 7 71-<76	Bin 8 76-<81	Bin 9 81-<86	Bin 10 86-<91	Bin 11 91-<96	Bin 12 96-<101	Bin 13 =>101
0:00	6	-	44.9	9.5	4	1	0	0	0	0	0	0	0	0	0	0	0
1:00	4	-	48.3	8.9	0	1	1	0	0	0	0	0	0	0	0	0	0
2:00	2	-	39.3	7.4	1	0	0	0	0	0	0	0	0	0	0	0	0
3:00	4	-	41.8	8.3	2	1	0	0	0	0	0	0	0	0	0	0	0
4:00	8	-	45.7	10.1	3	1	2	0	0	0	0	0	0	0	0	0	0
5:00	20	-	53.7	46.1	9	7	5	0	0	0	0	0	0	0	0	0	0
6:00	52	52.0	43.8	8.4	27	16	7	3	0	0	0	0	0	0	0	0	0
7:00	73	55.8	47.2	9.3	26	22	14	8	2	0	0	0	0	0	0	0	0
8:00	155	53.7	45.8	8.6	59	58	26	9	4	0	0	0	0	0	0	0	0
9:00	125	53.2	44.7	8.3	57	39	21	5	1	0	0	0	0	0	0	0	0
10:00	105	52.8	44.3	8.6	51	31	16	5	0	0	0	0	0	0	0	0	0
11:00	119	52.4	43.3	8.8	67	30	17	4	1	0	0	0	0	0	0	0	0
12:00	130	52.6	43.7	8.7	70	35	18	4	1	0	0	0	0	0	0	0	0
13:00	128	53.0	44.0	9.1	65	35	19	6	1	0	0	0	0	0	0	0	0
14:00	156	53.3	44.5	8.9	76	46	24	8	2	0	0	0	0	0	0	0	0
15:00	259	53.6	45.5	8.5	105	92	44	13	4	0	0	0	0	0	0	0	0
16:00	374	52.1	44.2	8.4	178	127	52	12	3	0	0	0	0	0	0	0	0
17:00	377	50.7	42.8	8.1	211	116	40	8	1	0	0	0	0	0	0	0	0
18:00	272	52.6	44.2	8.6	133	86	38	12	2	0	0	0	0	0	0	0	0
19:00	128	53.5	45.1	8.8	57	43	18	8	3	0	0	0	0	0	0	0	0
20:00	83	53.8	44.9	9.0	38	23	13	5	2	0	0	0	0	0	0	0	0
21:00	45	54.6	45.4	9.5	22	11	7	3	1	0	0	0	0	0	0	0	0
22:00	35	54.3	45.6	8.8	16	10	7	2	0	0	0	0	0	0	0	0	0
23:00	18	53.9	45.9	8.8	7	5	3	0	0	0	0	0	0	0	0	0	0
12H 7-19	2273	52.7	44.1	8.4	1099	717	329	96	24	1	0	0	0	0	0	0	0
16H 6-22	2581	52.8	44.2	8.4	1243	811	374	115	30	1	0	0	0	0	0	0	0
18H 6-24	2634	52.8	44.2	8.4	1266	826	384	117	30	1	0	0	0	0	0	0	0
24H 0-24	2678	52.8	44.2	8.4	1286	837	392	118	30	1	0	0	0	0	0	0	0
Am Peak	8:15 165	-	1:15 48.8	-	8:15 67	8:15 60	8:15 28	7:45 10	7:30 3	7:15 1	0:30 0	5:45 0	10:30 0	8:15 0	8:30 0	-	8:00 0
Pm Peak	16:30 392	21:15 54.7	21:45 46.0	21:00 9.5	16:30 218	16:00 127	15:30 57	15:30 16	15:15 4	15:30 2	18:15 1	21:30 0	18:00 0	23:00 0	15:00 0	-	16:00 0

Includes Local Events, Includes Global Events

B4451 Gaydon Road, Bishops Itchington
From 24/02/2016 To 02/03/2016

Speed Summary (Mon to Fri)-Limit 40 Mph

Channel: Northbound

Time	Total Vol.	85th %ile	Mean Ave.	Std. Dev.	Bin 1 <1Mph	Bin 2 1-<6	Bin 3 6-<11	Bin 4 11-<16	Bin 5 16-<21	Bin 6 21-<26	Bin 7 26-<31	Bin 8 31-<36	Bin 9 36-<41	Bin 10 41-<46	Bin 11 46-<51	Bin 12 51-<56	Bin 13 =>56
0:00	7	-	34.1	6.8	0	0	0	0	0	0	1	1	2	0	0	0	0
1:00	4	-	40.0	5.9	0	0	0	0	0	0	0	0	0	0	0	0	0
2:00	1	-	35.4	-	0	0	0	0	0	0	0	0	0	0	0	0	0
3:00	3	-	40.2	5.4	0	0	0	0	0	0	0	1	0	1	0	0	0
4:00	5	-	36.8	6.5	0	0	0	0	0	0	1	1	2	1	0	0	0
5:00	18	-	37.5	5.6	0	0	0	0	0	0	2	4	7	3	0	0	0
6:00	35	42.5	36.2	5.3	0	0	0	0	0	1	5	12	11	7	0	0	0
7:00	70	41.8	35.0	6.3	0	0	0	0	1	2	11	25	21	7	0	0	0
8:00	162	40.7	33.3	5.9	0	0	0	2	3	3	45	58	36	13	0	0	0
9:00	124	39.5	33.5	5.4	0	0	0	0	1	4	31	54	23	10	0	0	0
10:00	112	39.1	32.8	6.2	0	0	0	0	2	8	30	42	20	6	2	0	0
11:00	118	38.9	32.4	5.6	0	0	0	0	1	8	38	43	18	4	1	0	0
12:00	143	38.1	32.1	5.2	0	0	0	0	0	10	44	45	22	5	0	0	0
13:00	132	37.7	32.2	5.4	0	0	0	0	0	12	44	45	22	6	1	0	0
14:00	152	39.2	32.6	5.5	0	0	0	0	0	10	39	48	21	6	0	0	0
15:00	281	38.2	32.6	5.3	0	0	0	0	3	16	85	84	32	10	0	0	0
16:00	365	38.8	33.0	5.5	0	0	0	0	5	19	99	112	72	13	1	0	0
17:00	387	37.7	32.5	5.2	0	0	0	1	7	15	120	120	63	14	0	0	0
18:00	242	37.1	32.1	5.1	0	0	0	1	7	13	99	112	57	7	0	0	0
19:00	111	39.0	32.9	5.6	0	0	0	0	2	13	84	96	48	9	0	0	0
20:00	62	40.2	34.5	5.9	0	0	0	0	0	4	40	40	18	6	0	0	0
21:00	42	40.0	34.6	5.1	0	0	0	0	0	1	15	15	14	5	0	0	0
22:00	35	40.6	35.0	5.1	0	0	0	0	0	0	7	9	11	4	0	0	0
23:00	14	39.4	33.9	5.8	0	0	0	0	0	1	3	5	8	1	0	0	0

12H:7-19	2288	38.5	32.8	5.3	0	0	0	4	26	117	672	903	417	117	12	0	0
16H:6-22	2538	38.6	32.9	5.3	0	0	4	26	124	741	993	471	144	12	0	0	0
18H:6-24	2587	38.7	33.0	5.3	0	0	4	26	125	751	1012	482	149	12	0	0	0
24H:0-24	2625	38.8	33.0	5.4	0	0	4	26	125	755	1019	493	156	12	0	0	0
Am Peak	8:15	-	1:15	-	-	-	0:00	8:00	8:45	10:45	8:15	8:15	8:15	8:30	11:00	9:45	0:45
Pm Peak	16:30	21:30	21:30	20:45	-	-	15:30	16:30	16:30	16:30	16:30	16:30	16:15	16:15	16:15	20:30	14:30
	417	40.9	35.3	6.1	-	-	0	1	10	23	121	167	79	23	2	1	0

Includes Local Events, Includes Global Events

B4451 Gaydon Road, Bishops Itchington
From 24/02/2016 To 02/03/2016

Speed Summary (Mon to Fri)-Limit 40 Mph

Channel: Southbound

Time Begin	Total Vol.	85th %ile	Mean Ave.	Std. Dev.	Bin 1 <1Mph	Bin 2 1-<6	Bin 3 6-<11	Bin 4 11-<16	Bin 5 16-<21	Bin 6 21-<26	Bin 7 26-<31	Bin 8 31-<36	Bin 9 36-<41	Bin 10 41-<46	Bin 11 46-<51	Bin 12 51-<56	Bin 13 =>56
0:00	15	36.3	23.6	11.0	0	0	0	4	3	1	0	1	2	0	0	0	0
1:00	2	-	39.8	4.0	0	0	0	0	0	0	0	0	1	0	0	0	0
2:00	1	-	38.5	-	0	0	0	0	0	0	0	0	0	0	0	0	0
3:00	2	-	35.5	3.6	0	0	0	0	0	0	0	0	1	0	0	0	0
4:00	11	42.9	37.8	5.1	0	0	0	0	0	0	0	3	4	0	0	0	0
5:00	72	42.2	36.9	5.2	0	0	0	0	0	0	1	9	27	3	0	0	0
6:00	379	39.5	34.8	4.7	0	0	0	0	1	3	52	22	27	12	0	0	0
7:00	289	41.0	36.1	5.3	0	0	0	0	3	2	31	182	115	21	0	0	0
8:00	262	40.9	35.9	5.3	0	0	0	0	2	1	33	111	97	38	5	0	0
9:00	145	40.1	35.3	4.8	0	0	0	0	1	1	19	60	88	33	4	0	0
10:00	104	40.4	35.0	5.6	0	0	1	0	0	1	16	40	50	11	1	0	0
11:00	99	40.5	35.4	5.3	0	0	0	0	1	1	32	38	33	12	1	0	0
12:00	117	40.4	35.3	5.5	0	0	0	0	1	1	17	49	37	11	0	0	0
13:00	116	40.5	34.9	6.1	0	0	1	0	1	1	18	45	35	13	0	0	0
14:00	114	40.5	35.6	5.8	0	0	0	0	0	2	14	45	40	10	0	0	0
15:00	127	40.8	36.0	5.1	0	0	0	0	1	1	19	49	45	15	2	0	0
16:00	167	40.7	35.7	5.3	0	0	0	0	1	2	14	65	57	19	2	0	0
17:00	179	40.4	35.6	5.1	0	0	0	0	3	1	22	67	67	18	2	0	0
18:00	111	39.6	34.4	5.1	0	0	0	0	0	2	20	47	29	8	0	0	0
19:00	56	40.5	35.3	5.2	0	0	0	0	0	0	8	27	13	6	0	0	0
20:00	30	40.5	35.3	5.7	0	0	0	0	0	0	6	12	8	4	0	0	0
21:00	27	40.0	34.4	5.4	0	0	0	0	0	0	5	10	7	4	0	0	0
22:00	19	40.3	35.6	5.0	0	0	0	0	0	0	3	7	6	1	0	0	0
23:00	8	-	36.4	4.8	0	0	0	0	0	0	1	3	3	0	0	0	0
12H:7-19	1830	40.6	35.5	5.2	0	0	3	1	14	17	236	717	610	199	23	0	0
16H:6-22	2322	40.4	35.4	5.1	0	0	3	1	15	20	307	948	753	234	26	0	0
18H:6-24	2349	40.4	35.4	5.1	0	0	3	1	15	20	311	958	762	235	26	0	0
24H:0-24	2452	40.5	35.4	5.2	0	0	3	5	18	21	321	984	797	250	27	0	0
Am Peak	6:15 405	-	1:15 40.6	-	-	-	10:30 1	0:15 4	6:45 3	6:30 5	6:15 53	6:15 197	6:30 119	7:00 38	7:00 5	8:15 1	11:00 0
Pm Peak	16:45 188	-	22:45 36.8	13:15 6.8	-	-	13:30 2	13:00 1	16:45 3	13:45 3	16:45 24	16:45 74	17:00 66	16:15 21	16:30 3	13:45 1	12:00 0

B4451 Gaydon Road S of Plough Lane B Itchington
From 24/02/2016 To 02/03/2016

Speed Summary (Mon to Fri)-Limit 40 Mph

Channel: Northbound

Time	Total Vol.	85th %ile	Mean Ave.	Std. Dev.	Bin 1 <1Mph	Bin 2 1-<6	Bin 3 6-<11	Bin 4 11-<16	Bin 5 16-<21	Bin 6 21-<26	Bin 7 26-<31	Bin 8 31-<36	Bin 9 36-<41	Bin 10 41-<46	Bin 11 46-<51	Bin 12 51-<56	Bin 13 =>56
0:00	5	-	26.6	4.5	0	0	0	0	0	0	0	0	0	0	0	0	0
1:00	4	-	30.8	5.8	0	0	0	0	0	0	0	0	0	0	0	0	0
2:00	1	-	27.3	4.0	0	0	0	0	0	0	0	0	0	0	0	0	0
3:00	3	-	29.4	3.3	0	0	0	0	0	0	0	0	0	0	0	0	0
4:00	4	-	26.4	5.8	0	0	0	0	0	0	0	0	0	0	0	0	0
5:00	18	-	31.7	4.8	0	0	0	0	0	0	0	0	0	0	0	0	0
6:00	50	29.1	24.3	4.6	0	0	0	0	0	0	0	0	0	0	0	0	0
7:00	165	26.5	22.9	4.0	0	0	0	0	0	0	0	0	0	0	0	0	0
8:00	248	27.1	23.0	4.2	0	0	0	0	0	0	0	0	0	0	0	0	0
9:00	156	27.7	23.2	4.5	0	0	0	0	0	0	0	0	0	0	0	0	0
10:00	134	27.5	23.5	4.0	0	0	0	0	0	0	0	0	0	0	0	0	0
11:00	147	27.4	22.9	4.7	0	0	0	0	0	0	0	0	0	0	0	0	0
12:00	176	27.3	23.2	4.1	0	0	0	0	0	0	0	0	0	0	0	0	0
13:00	162	27.6	23.2	4.3	0	0	0	0	0	0	0	0	0	0	0	0	0
14:00	176	28.2	23.6	4.3	0	0	0	0	0	0	0	0	0	0	0	0	0
15:00	314	27.6	22.8	4.6	0	0	0	0	0	0	0	0	0	0	0	0	0
16:00	400	27.5	23.2	4.3	0	0	0	0	0	0	0	0	0	0	0	0	0
17:00	401	26.7	23.2	3.9	0	0	0	0	0	0	0	0	0	0	0	0	0
18:00	259	28.0	23.1	4.0	0	0	0	0	0	0	0	0	0	0	0	0	0
19:00	123	26.7	23.8	4.1	0	0	0	0	0	0	0	0	0	0	0	0	0
20:00	66	29.2	24.7	4.5	0	0	0	0	0	0	0	0	0	0	0	0	0
21:00	44	29.0	25.0	3.6	0	0	0	0	0	0	0	0	0	0	0	0	0
22:00	39	29.5	25.3	3.8	0	0	0	0	0	0	0	0	0	0	0	0	0
23:00	14	29.1	25.0	4.4	0	0	0	0	0	0	0	0	0	0	0	0	0
12H:7-19	2739	27.4	23.2	4.2	0	0	0	0	0	0	0	0	0	0	0	0	0
16H:6-22	3022	27.5	23.3	4.2	0	0	0	0	0	0	0	0	0	0	0	0	0
18H:6-24	3075	27.6	23.3	4.2	0	0	0	0	0	0	0	0	0	0	0	0	0
24H:0-24	3110	27.7	23.3	4.3	0	0	0	0	0	0	0	0	0	0	0	0	0
Am Peak	8:15 249	-	1:15 31.6	-	-	7:30 0	8:15 2	8:15 11	8:00 51	8:15 138	8:15 46	5:30 4	0:45 1	4:30 0	-	-	-
Pm Peak	16:30 441	22:00 29.5	22:00 25.3	15:00 4.6	-	15:45 0	15:30 7	15:30 17	16:30 76	16:30 263	16:15 87	16:15 5	23:00 0	-	-	-	

B4451 Gaydon Road S of Plough Lane B Itchington
From 24/02/2016 To 02/03/2016

Speed Summary (Mon to Fri)-Limit 40 Mph

Channel: Southbound

Time	Total Vol.	85th %ile	Mean Ave.	Std. Dev.	Bin 1 <1Mph	Bin 2 1-<6	Bin 3 6-<11	Bin 4 11-<16	Bin 5 16-<21	Bin 6 21-<26	Bin 7 26-<31	Bin 8 31-<36	Bin 9 36-<41	Bin 10 41-<46	Bin 11 46-<51	Bin 12 51-<56	Bin 13 =>56
0:00	11	31.5	21.0	9.3	0	0	1	3	1	1	0	2	0	0	0	0	0
1:00	2	-	29.8	-	0	0	0	0	0	0	0	0	0	0	0	0	0
2:00	1	-	28.5	-	0	0	0	0	0	0	0	0	0	0	0	0	0
3:00	2	-	28.0	4.5	0	0	0	0	0	0	0	0	0	0	0	0	0
4:00	11	33.9	29.7	4.9	0	0	0	0	0	0	0	0	0	0	0	0	0
5:00	69	35.2	30.2	5.1	0	0	0	0	0	2	4	3	0	0	0	0	0
6:00	389	31.7	27.5	4.6	0	0	1	6	2	11	24	23	7	0	0	0	0
7:00	352	30.7	26.7	4.6	0	0	0	4	4	101	202	59	7	0	0	0	0
8:00	291	30.9	26.9	4.4	0	0	0	2	16	129	158	38	6	0	0	0	0
9:00	164	30.9	26.6	4.7	0	0	0	2	16	100	131	39	3	0	0	0	0
10:00	134	30.9	26.4	5.0	0	0	0	1	13	53	70	20	3	0	0	0	0
11:00	125	30.5	26.0	4.8	0	0	0	1	14	48	50	16	3	0	0	0	0
12:00	141	30.6	26.1	4.7	0	0	0	2	14	46	47	13	1	0	0	0	0
13:00	144	31.4	26.6	4.8	0	0	0	1	11	57	51	15	2	0	0	0	0
14:00	141	31.1	26.6	4.9	0	0	0	1	12	52	47	11	2	0	0	0	0
15:00	157	30.8	26.2	4.9	0	0	1	2	11	63	58	22	3	0	0	0	0
16:00	217	30.8	26.3	5.0	0	0	0	3	19	82	84	25	4	0	0	0	0
17:00	233	30.9	26.2	5.0	0	0	0	6	19	87	87	32	3	0	0	0	0
18:00	153	30.4	25.7	4.7	0	0	0	2	16	66	50	14	2	0	0	0	0
19:00	83	30.6	25.9	5.0	0	0	0	2	5	37	28	10	2	0	0	0	0
20:00	49	31.4	26.4	5.7	0	0	1	0	4	18	17	7	1	0	0	0	0
21:00	40	32.2	27.0	5.4	0	0	0	0	5	14	13	6	2	0	0	0	0
22:00	23	32.7	28.0	4.8	0	0	0	0	1	7	9	4	0	0	0	0	0
23:00	11	33.8	28.3	5.5	0	0	0	0	0	3	4	2	0	0	0	0	0
12H,7-19	2251	30.8	26.4	4.7	0	0	1	25	176	838	894	274	34	1	0	0	0
16H,6-22	2812	30.9	26.6	4.8	0	0	3	33	203	1008	1154	356	46	1	0	0	0
18H,6-24	2846	30.9	26.6	4.8	0	0	3	33	204	1018	1167	362	46	1	0	0	0
24H,0-24	2942	31.1	26.7	4.8	0	0	4	36	207	1032	1195	391	54	1	0	0	0
Am Peak	6:30 442	-	4:30 30.4	-	-	-	6:45 1	6:45 8	6:30 20	6:30 142	6:15 226	6:00 60	5:45 10	6:00 1	11:00 0	-	-
Pm Peak	16:45 243	23:00 33.8	22:30 28.6	20:00 5.7	-	17:45 0	19:15 1	17:15 6	17:15 21	16:45 90	16:45 95	17:00 31	16:15 4	14:00 1	22:30 0	-	-

Includes Local Events, Includes Global Events

B4451 Station Road Bishops Itchington
From 24/02/2016 To 02/03/2016

Speed Summary (Mon to Fri)-Limit 40 Mph

Channel: Northbound

Time	Total Vol.	85th %ile	Mean Ave.	Std. Dev.	Bin 1 <1Mph	Bin 2 1-<6	Bin 3 6-<11	Bin 4 11-<16	Bin 5 16-<21	Bin 6 21-<26	Bin 7 26-<31	Bin 8 31-<36	Bin 9 36-<41	Bin 10 41-<46	Bin 11 46-<51	Bin 12 51-<56	Bin 13 =>56
0:00	2	-	35.2	5.4	0	0	0	0	0	0	0	0	0	0	0	0	0
1:00	4	-	41.9	2.8	0	0	0	0	0	0	0	1	0	0	0	0	0
2:00	2	-	46.5	-	0	0	0	0	0	0	0	0	0	0	0	0	0
3:00	1	-	34.1	-	0	0	0	0	0	0	0	0	0	0	0	0	0
4:00	5	-	38.7	4.2	0	0	0	0	0	0	0	0	2	0	0	0	0
5:00	20	-	38.6	5.5	0	0	0	0	0	0	0	5	5	1	0	0	0
6:00	41	44.4	37.5	5.7	0	0	0	0	0	1	2	11	19	8	0	0	0
7:00	128	42.2	36.6	5.9	0	0	0	0	0	0	11	21	44	19	5	0	0
8:00	185	40.2	35.8	5.7	0	0	0	0	0	0	21	21	60	21	24	0	0
9:00	120	41.2	34.6	5.7	0	0	0	0	0	0	16	16	45	34	45	0	0
10:00	98	40.1	34.6	5.4	0	0	0	0	0	0	22	22	43	26	30	0	0
11:00	110	40.8	34.9	6.1	0	0	0	0	0	0	17	17	43	30	30	0	0
12:00	124	40.4	34.6	5.6	0	0	0	0	0	0	21	21	48	35	42	0	0
13:00	113	40.4	34.4	6.3	0	0	0	0	0	0	17	24	48	30	30	0	0
14:00	125	40.6	35.0	6.1	0	0	0	0	0	0	22	43	43	38	44	0	0
15:00	210	40.9	35.6	5.8	0	0	0	0	0	0	4	7	38	38	44	0	0
16:00	285	41.4	35.5	6.3	0	0	0	0	0	0	5	5	65	65	76	0	0
17:00	256	41.1	35.7	5.7	0	0	0	0	0	0	8	10	84	84	105	0	0
18:00	161	40.8	35.3	5.7	0	0	0	0	0	0	4	4	76	76	105	0	0
19:00	67	42.2	35.6	6.6	0	0	0	0	0	0	4	4	44	44	67	0	0
20:00	38	41.8	35.8	7.2	0	0	0	0	0	0	1	1	17	17	25	0	0
21:00	28	41.5	36.1	5.4	0	0	0	0	0	0	6	6	11	11	14	0	0
22:00	23	42.4	36.8	5.9	0	0	0	0	0	0	5	5	8	8	11	0	0
23:00	8	-	34.9	4.8	0	0	0	0	0	0	2	2	8	8	6	0	0

Time	Total Vol.	85th %ile	Mean Ave.	Std. Dev.
12H 7-19	1916	40.8	35.3	5.7
16H 6-22	2090	40.9	35.4	5.7
18H 6-24	2121	40.9	35.4	5.7
24H 0-24	2155	41.0	35.5	5.7
Am Peak	8:00	-	2:00	-
	185	-	46.5	-
Pm Peak	16:15	-	21:30	20:00
	292	-	37.4	7.2

B4451 Station Road Bishops Itchington
From 24/02/2016 To 02/03/2016

Speed Summary (Mon to Fri)-Limit 40 Mph

Channel: Southbound

Time Begin	Total Vol.	85th %ile	Mean Ave.	Std. Dev.	Bin 1 <1Mph	Bin 2 1-<6	Bin 3 6-<11	Bin 4 11-<16	Bin 5 16-<21	Bin 6 21-<26	Bin 7 26-<31	Bin 8 31-<36	Bin 9 36-<41	Bin 10 41-<46	Bin 11 46-<51	Bin 12 51-<56	Bin 13 =>56
0:00	3	-	34.5	5.1	0	0	0	0	0	0	2	1	0	0	0	0	0
1:00	1	-	38.5	-	0	0	0	0	0	0	0	0	0	0	0	0	0
2:00	1	-	37.5	-	0	0	0	0	0	0	0	0	1	0	0	0	0
3:00	0	-	30.5	-	0	0	0	0	0	0	0	0	0	0	0	0	0
4:00	6	-	36.8	5.4	0	0	0	0	0	0	0	0	0	0	0	0	0
5:00	49	-	34.7	6.0	0	0	0	0	0	0	0	3	2	1	0	0	0
6:00	246	40.3	37.1	4.8	0	0	0	1	1	6	10	15	3	5	0	0	0
7:00	211	37.2	32.4	5.4	0	0	0	1	3	8	84	106	38	8	0	0	0
8:00	193	37.4	31.9	5.6	0	0	1	0	3	11	64	95	33	7	0	0	0
9:00	113	35.6	29.3	7.0	0	0	2	0	4	11	65	74	30	6	1	0	0
10:00	106	36.3	30.6	6.8	0	0	1	5	4	8	33	35	13	2	0	0	0
11:00	98	37.0	31.1	6.0	0	0	0	2	2	5	42	29	16	1	0	0	0
12:00	104	36.5	31.6	5.1	0	0	0	0	2	9	36	40	14	3	0	0	0
13:00	103	37.1	31.5	6.1	0	0	1	1	3	9	32	38	17	3	0	0	0
14:00	100	37.0	31.6	5.9	0	0	0	1	4	6	35	37	14	3	0	0	0
15:00	125	37.0	31.8	5.4	0	0	0	0	5	8	41	48	18	2	0	0	0
16:00	163	36.7	31.7	4.9	0	0	0	0	0	9	70	56	25	2	0	0	0
17:00	210	36.2	31.5	4.9	0	0	0	0	2	15	82	78	31	3	0	0	0
18:00	107	35.5	31.0	4.8	0	0	0	0	0	12	45	36	10	2	0	0	0
19:00	58	35.8	31.4	5.3	0	0	0	0	0	4	24	21	8	1	0	0	0
20:00	36	38.1	32.6	5.1	0	0	0	0	0	3	12	13	7	2	0	0	0
21:00	29	37.5	32.0	5.5	0	0	0	0	0	1	12	9	6	0	0	0	0
22:00	21	38.3	33.4	4.9	0	0	0	0	0	0	4	10	4	0	0	0	0
23:00	10	-	33.2	5.2	0	0	0	0	0	0	2	6	1	0	0	0	0
12H:7-19	1632	36.6	31.4	5.5	0	0	5	18	32	110	583	605	233	37	2	0	0
16H:6-22	2001	36.7	31.6	5.4	0	0	5	19	33	126	715	754	292	48	2	0	0
18H:6-24	2032	36.7	31.6	5.4	0	0	5	19	33	126	721	770	297	48	2	0	0
24H:0-24	2092	37.0	31.7	5.4	0	0	5	19	33	129	732	788	317	54	2	0	0
Am Peak	6:15 273	-	40.5	-	-	9:45 0	9:30 3	9:30 7	9:30 7	8:45 13	6:15 92	6:15 122	5:45 40	5:45 9	8:15 1	-	-
Pm Peak	17:00 210	-	33.9	6.8	-	-	13:15 1	13:15 2	13:15 4	17:15 18	17:00 82	16:45 78	16:45 31	14:15 5	15:45 1	23:00 0	-

B4451 Station Road, Bishops Itchington
From 24/02/2016 To 02/03/2016

Speed Summary (Mon to Fri)-Limit 40 Mph

Channel: Northbound

Time Begin	Total Vol.	85th %ile	Mean Ave.	Std. Dev.	Bin 1 <1Mph	Bin 2 1-<6	Bin 3 6-<11	Bin 4 11-<16	Bin 5 16-<21	Bin 6 21-<26	Bin 7 26-<31	Bin 8 31-<36	Bin 9 36-<41	Bin 10 41-<46	Bin 11 46-<51	Bin 12 51-<56	Bin 13 =>56
0:00	4	-	27.5	5.1	0	0	0	0	0	1	2	0	0	0	0	0	0
1:00	4	-	35.4	6.5	0	0	0	0	0	0	0	0	1	1	0	0	0
2:00	2	-	36.5	3.6	0	0	0	0	0	0	0	0	1	0	0	0	0
3:00	1	-	31.0	3.5	0	0	0	0	0	0	0	0	0	0	0	0	0
4:00	5	-	33.3	6.6	0	0	0	0	0	1	0	1	5	0	0	0	0
5:00	21	-	32.2	6.0	0	0	0	0	1	1	8	5	5	0	0	0	0
6:00	45	38.0	30.3	6.7	0	0	0	0	1	6	15	16	5	0	0	0	0
7:00	139	35.6	29.4	5.0	0	0	0	0	2	28	60	38	9	1	0	0	0
8:00	192	34.6	29.3	4.7	0	0	0	0	5	32	92	52	10	1	0	0	0
9:00	126	34.2	28.1	5.2	0	0	0	0	5	32	50	29	5	0	0	0	0
10:00	102	33.9	28.7	4.7	0	0	0	2	4	19	46	28	3	0	0	0	0
11:00	117	33.9	28.5	5.9	0	0	1	2	4	22	49	29	6	0	0	0	0
12:00	126	34.2	28.9	4.6	0	0	0	1	3	25	59	32	6	0	0	0	0
13:00	118	34.0	28.4	6.0	0	0	1	0	5	23	54	25	7	0	0	0	0
14:00	129	33.8	28.5	5.3	0	0	1	1	4	28	59	28	7	0	0	0	0
15:00	129	34.2	29.0	4.9	0	0	0	1	5	44	94	55	10	1	0	0	0
16:00	291	34.3	29.3	5.0	0	0	0	2	8	45	141	78	16	4	0	0	0
17:00	267	34.2	29.2	5.0	0	0	0	2	3	44	130	73	12	1	0	0	0
18:00	166	34.4	29.2	5.0	0	0	0	0	6	27	78	42	10	0	0	0	0
19:00	70	35.1	29.9	5.2	0	0	0	0	2	12	26	22	6	0	0	0	0
20:00	40	35.2	29.6	6.0	0	0	0	0	1	9	16	10	3	0	0	0	0
21:00	30	35.0	30.0	5.1	0	0	0	0	1	5	14	6	3	0	0	0	0
22:00	24	35.3	30.0	5.9	0	0	0	0	1	3	9	9	1	0	0	0	0
23:00	8	-	30.0	4.8	0	0	0	0	0	1	4	2	1	0	0	0	0
12H:7-19	1988	34.2	29.0	4.9	0	0	0	13	52	370	912	509	102	8	0	0	0
16H:6-22	2173	34.3	29.1	4.9	0	0	13	56	402	402	983	563	119	8	0	0	0
18H:6-24	2205	34.3	29.1	4.9	0	0	13	57	406	406	996	574	121	8	0	0	0
24H:0-24	2242	34.3	29.1	4.9	0	0	13	58	409	409	1006	580	129	9	0	0	0
Am Peak	8:00 193	-	2:00 36.5	-	-	6:30 1	11:00 2	11:00 2	8:45 6	8:30 34	8:00 92	8:00 52	6:45 10	8:30 2	9:45 0	-	-
Pm Peak	16:15 302	-	21:15 30.7	22:30 6.7	-	16:15 1	16:45 2	16:30 3	15:45 10	16:30 46	16:15 147	16:15 83	16:30 15	16:15 4	17:45 0	21:45 0	-

B4451 Station Road, Bishops Itchington
From 24/02/2016 To 02/03/2016

Speed Summary (Mon to Fri)-Limit 40 Mph

Channel: Southbound

Time	Total Vol.	85th %ile	Mean Ave.	Std. Dev.	Bin 1 <1Mph	Bin 2 1-<6	Bin 3 6-<11	Bin 4 11-<16	Bin 5 16-<21	Bin 6 21-<26	Bin 7 26-<31	Bin 8 31-<36	Bin 9 36-<41	Bin 10 41-<46	Bin 11 46-<51	Bin 12 51-<56	Bin 13 =>56
0:00	12	31.8	21.7	8.1	0	0	0	5	3	1	1	2	0	0	0	0	0
1:00	1	-	36.3	-	0	0	0	0	0	0	0	0	0	0	0	0	0
2:00	1	-	35.5	-	0	0	0	0	0	0	0	0	0	0	0	0	0
3:00	1	-	31.5	-	0	0	0	0	0	0	0	0	0	0	0	0	0
4:00	6	-	35.2	4.4	0	0	0	0	0	0	0	2	3	0	0	0	0
5:00	47	-	34.4	4.9	0	0	0	0	0	0	0	18	14	3	0	0	0
6:00	246	39.6	31.6	4.3	0	0	0	0	1	1	10	18	26	4	0	0	0
7:00	214	35.2	30.9	4.7	0	0	0	0	0	1	14	99	79	3	0	0	0
8:00	191	35.2	30.5	4.6	0	0	0	0	2	2	23	67	17	2	0	0	0
9:00	115	33.4	28.5	4.7	0	0	0	0	3	2	57	83	14	4	0	0	0
10:00	109	33.5	28.8	4.5	0	0	0	0	2	2	24	55	5	5	0	0	0
11:00	100	33.5	28.4	5.1	0	0	0	0	2	2	26	46	18	7	0	0	0
12:00	107	33.9	29.0	4.9	0	0	0	0	2	2	20	52	44	5	0	0	0
13:00	104	34.4	29.1	5.6	0	0	0	0	3	3	21	44	28	5	1	0	0
14:00	102	33.8	28.7	5.1	0	0	1	0	3	3	20	51	44	21	0	0	0
15:00	129	33.9	28.6	5.1	0	0	0	0	4	4	29	57	57	30	6	0	0
16:00	168	34.0	29.0	4.7	0	0	0	0	3	3	35	77	41	8	0	0	0
17:00	210	34.3	29.5	4.6	0	0	0	0	1	1	33	106	56	12	0	0	0
18:00	109	34.0	29.3	4.5	0	0	0	0	1	1	19	55	26	6	0	0	0
19:00	60	34.7	29.9	4.8	0	0	0	0	1	1	9	28	17	4	0	0	0
20:00	37	36.6	30.9	5.6	0	0	0	0	0	0	5	15	10	5	0	0	0
21:00	29	35.3	30.5	5.2	0	0	0	0	0	0	5	12	9	3	0	0	0
22:00	21	36.2	31.8	5.2	0	0	0	0	0	0	2	7	3	3	0	0	0
23:00	10	-	32.7	6.1	0	0	0	0	0	1	2	3	2	0	0	0	0

12H:7-19 1657 34.4 29.4 4.7
 16H:6-22 2029 34.7 29.7 4.7
 18H:6-24 2060 34.7 29.7 4.7
 24H:0-24 2128 34.8 29.8 4.8

Am Peak 6:15 274 1:15 36.5
 Pm Peak 16:45 211 22:30 32.8 22:45 6.2

Appendix 4

WARWICKSHIRE COUNTY COUNCIL (B4451 GAYDON ROAD & STATION ROAD, BISHOPS ITCHINGTON) (30, 40 & 50 MPH SPEED LIMIT) ORDER 2017 BISHOP ITCHINGTON – PROPOSED TRAFFIC CALMING

JUNE 8, 2017 BY ROAD SAFETY WARWICKSHIRE
([HTTPS://WCCROADSAFETYENGINEERING.WORDPRESS.COM/AUTHOR/ROADSAFETY1/](https://wccroadsafetyengineering.wordpress.com/author/roadsafety1/))

Warwickshire County Council propose to make the above Order under the Road Traffic Regulation Act 1984 the effect of which will be to impose 30, 40 & 50 mph speed limits on the lengths of road mentioned in the Schedules below.

A copy of the proposed Order, together with a plan showing the length of road affected and a statement of the Council's reasons for proposing to make the Order, may be inspected at the Main Reception, Shire Hall, Market Place, Warwick, at the Stratford-upon-Avon District Council Elizabeth House Church Street Stratford-upon-Avon Warwickshire CV37 6HX and at the Harbury Community Library The Wight School High Street Harbury Leamington Spa CV33 9HW during usual opening hours.

Any enquiries relating to the proposals may be made to Debbie Poynton, Communities Group, Warwickshire County Council (telephone number: 01926 412076).

Any objections to the proposals, which must be in writing and specify the grounds on which they are made, should be addressed to Debbie Poynton, Communities Group, PO Box 43, Shire Hall, Warwick, CV34 4SX. (Objections, and the name of the objector, will normally be treated as public information and may be published.) Objections must be sent so as to be received by 7 July 2017.

SCHEDULE 1

(30 mph Speed Limit)

Length of road in Bishop's Itchington

1. B4451 Gaydon Road & Station Road

That length of road from a point 64 metres south west of the boundary between property number 41 / 43 Gaydon Road in a generally north easterly then north westerly direction to a point 119 metres north west of the junction with Marlow Green (centre of junction)

2. Plough Lane

From its junction with the B4451 Gaydon Road in a north westerly direction to a point 73 metres north west of its junction with Manor Road (centre of junction).

3. Knightcote Road

From its junction with the B4451 Gaydon Road in a generally south easterly direction for a distance of 216 metres.

SCHEDULE 2

(40 mph Speed Limit)

1. B4451 Gaydon Road

That length of road from a point 737 metres south west of its junction with Knightcote Road in a generally north easterly direction to a point 64 metres south west of the property boundary between property number 41 / 43 Gaydon Road.

2. B4451 Station Road

That length of road from a point 119 metres north of the junction with Marlow Green in a north easterly direction to a point 21 metres north of the boundary between Walworth Farm and the Chapel Cemetery.

SCHEDULE 3
(50 mph Speed Limit)

1. B4451 Station Road

That length of road from a point 21 metres north of the boundary between Walworth Farm and the Chapel Cemetery to its junction with the B4452 / B4451 Deppers Bridge Road.

SCHEDULE 4
(Provisions that are revoked)

1. The Warwickshire County Council (40 M.P.H SPEED LIMIT) (B4451 BISHOPS ITCHINGTON) ORDER, 1971 (Entire Order)
2. THE WARWICKSHIRE COUNTY COUNCIL (PLOUGH LANE, BISHOPS ITCHINGTON)(40 M.P.H SPEED LIMIT) ORDER 1994 – (No 289) (Entire Order)
3. THE WARWICKSHIRE COUNTY COUNCIL (VARIOUS ROADS, DISTRICT OF STRATFORD ON AVON) (SPEED LIMIT) ORDER 2009 – (No 483)

Schedule 1 (50 MPH SPEED LIMIT)

Item 30

B4451 Deppers Bridge / Station Road

From its junction with the B4451 Deppers Bridge, southwards for a distance of 850 metres

4. The Warwickshire County Council (B4100 Banbury Road, B4100 Warwick Road, B4100 Link Road, B4451 Gaydon Road, Gaydon, Bishops Itchington and Lighthorne Heath) (40 MPH & 50 MPH Speed Limit & 30 MPH Speed Limit Variation) Order 2016

Schedule 1 (40mph Speed Limits)

Item 2

B4451 Gaydon Road, Bishops Itchington

From a point 427 metres south west of its junction with Knightcote Road, south westwards for a distance of 310 metres.

[speed limit plans \(https://wccroadsafetyengineering.files.wordpress.com/2017/06/speed-limit-plans.pdf\)](https://wccroadsafetyengineering.files.wordpress.com/2017/06/speed-limit-plans.pdf)

[General consultation letter \(https://wccroadsafetyengineering.files.wordpress.com/2017/06/general-consultation-letter.docx\)](https://wccroadsafetyengineering.files.wordpress.com/2017/06/general-consultation-letter.docx)

B4451 GAYDON ROAD & STATION ROAD, BISHOPS ITCHINGTON – PROPOSED TRAFFIC CALMING

Warwickshire County Council propose to install traffic calming measures as described and in the locations outlined in the Schedule below in Bishops Itchington.

A copy of the plan showing the proposed locations of the traffic calming measures and a statement of the Council's reasons for proposing to install them may be inspected at the Main Reception, Shire Hall, Market Place, Warwick; at the Stratford-upon-Avon District Council Elizabeth House Church Street Stratford-upon-Avon Warwickshire CV37 6HX and at the Harbury Community Library The Wight School High Street Harbury Leamington Spa CV33 9HW during usual opening hours.

Any enquiries relating to the proposals may be made to Debbie Poynton, Communities Group, Warwickshire County Council (telephone number: 01926 412076). Any objections to the proposals, which must be in writing and specify the grounds on which they are made, should be addressed to Debbie Poynton, Communities Group, PO Box 43, Shire Hall, Warwick, CV34 4SX. (Objections, and the name of the objector, will normally be treated as public information and may be published.) Objections must be sent so as to be received by 7 July 2017.

SCHEDULE
B4451 Gaydon Road

- 1 No. 75mm high speed cushions (two cushions at each location) to be located outside property number 37 Gaydon Road.
- 1 No. 75mm high speed cushions (two cushions at each location) to be located between property number 29 and 27 Gaydon Road.

- 1 No. 75mm high speed cushions (two cushions at each location) to be located to the northeast of the junction with Knightcote Road, speed cushion is to be in line with the existing manhole cover.
- 1 No. 75mm high raised table at the junction with Plough Lane
- 1 No. 75mm high speed cushions (two cushions at each location) to be located outside property number 6 Gaydon Road.
- 1 No. 75mm high speed cushions (two cushions at each location) to be located outside property number 5 Gaydon Road.

B4451 Station Road

- 1 No. 75mm high speed cushions (two cushions at each location) to be located outside property number 4 Station Road.
- 1 No. 75mm high speed cushions (two cushions at each location) to be located outside property number 19A Station Road, cushion will be in line with the existing school sign.

[traffic calming plans \(https://wccroadsafetyengineering.files.wordpress.com/2017/06/traffic-calming-plans.pdf\)](https://wccroadsafetyengineering.files.wordpress.com/2017/06/traffic-calming-plans.pdf)

[General consultation letter \(https://wccroadsafetyengineering.files.wordpress.com/2017/06/general-consultation-letter1.docx\)](https://wccroadsafetyengineering.files.wordpress.com/2017/06/general-consultation-letter1.docx)

Advertisements

FILED UNDER [STRATFORD DISTRICT](#) TAGGED WITH [SPEED LIMIT](#), [TRAFFIC CALMING](#)

Comments are closed.

[Blog at WordPress.com.](#)

Paragraph to be included in Committee Reports relating to Speed Limit Orders

The Road Traffic Regulation Act 1984 enables the Council to make Orders prohibiting the driving of motor vehicles on a road at a speed exceeding that specified in the Order, or directing that a road on which there is provided a system of street lighting furnished by means of lamps placed not more than 183 metres apart shall become a restricted road (subject to a speed limit of 30 mph) or that it shall cease to be a restricted road.

Speed Limit Orders and Restricted Road Orders remain in force until superseded or revoked.

The Department for Transport's Circular 01/2013 'New Guidance On Setting Local Speed Limits' should be the basis for assessments of local speed limits, for developing route management strategies and for developing speed management strategies required as part of the Local Transport Plan process. Circular 01/2013 requires that "speed limits should be evidence-led, self-explaining and seek to reinforce people's assessment of what is a safe speed to travel. They should encourage self-compliance and should not be seen by drivers as being a target speed at which to drive in all circumstances. Traffic authorities set 'local speed limits' in situations where local needs and considerations deem it desirable for drivers to adopt a speed which is different from the national speed limit. Local speed limits could be reduced or increased, depending upon the conditions and evidence."

In deciding whether or not to make an Order or give a Direction, the Council is required to have regard to the matters set out in section 122 of the 1984 Act. Section 122(1) requires the Council to exercise the functions conferred on it by the 1984 Act as (so far as practicable having regard to the matters specified in section 122(2)) to secure the expeditious, convenient and safe movement of vehicular and other traffic (including pedestrians), and the provision of suitable and adequate parking facilities on and off the highway.

The matters to which the Council must have regard are:-

- the desirability of securing and maintaining reasonable access to premises
- the effect on the amenities of any locality affected and the importance of regulating and restricting the use of roads by heavy commercial vehicles so as to preserve or improve the amenities of the areas through which the roads run
- the national air quality strategy prepared under section 80 of the Environmental Protection Act 1995
- the importance of facilitating the passage of public service vehicles and of securing the safety and convenience of persons using or desiring to use such vehicles
- and any other matters appearing to the Council to be relevant

Therefore whilst the overall objective of the Council must be to secure the expeditious convenient and safe movement of vehicular traffic this cannot prevent statutory powers from being used for the specific purposes identified in section 122(1) and that a balance has to be achieved between the overall objective and the matters set out in section 122(2).